

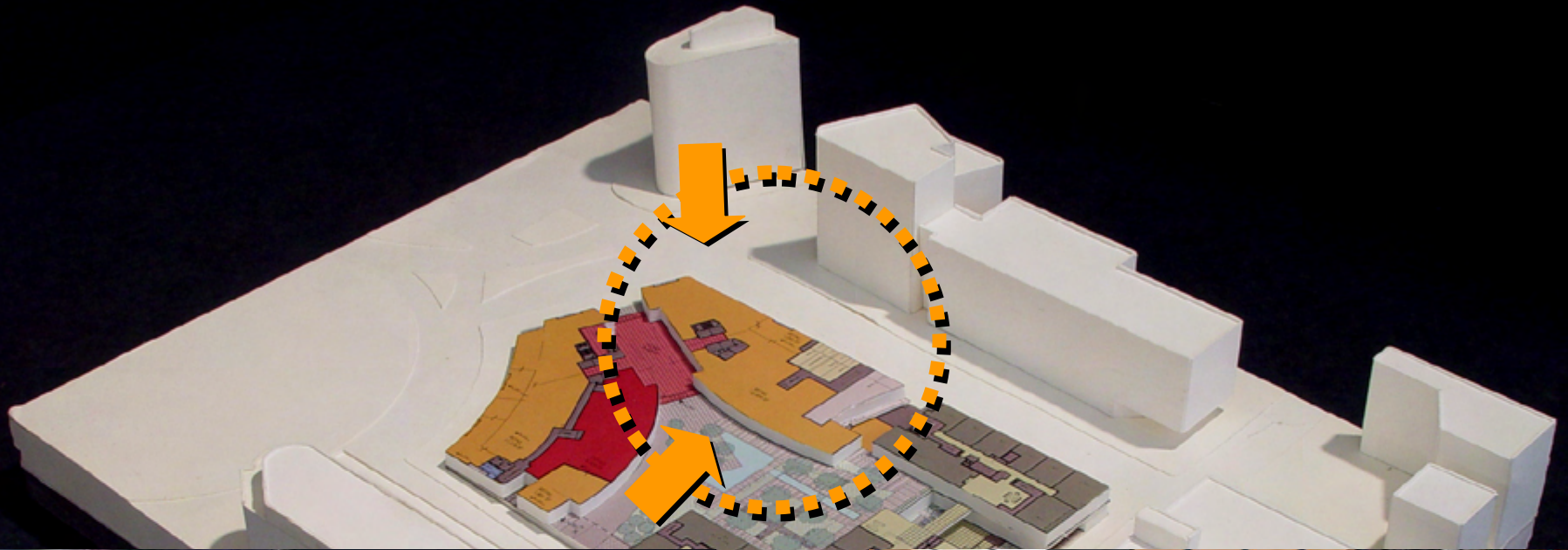

GROUND FLOOR RETAIL PLAN

COPYRIGHT © 2006 - PELL CLARK PELL ARCHITECTS

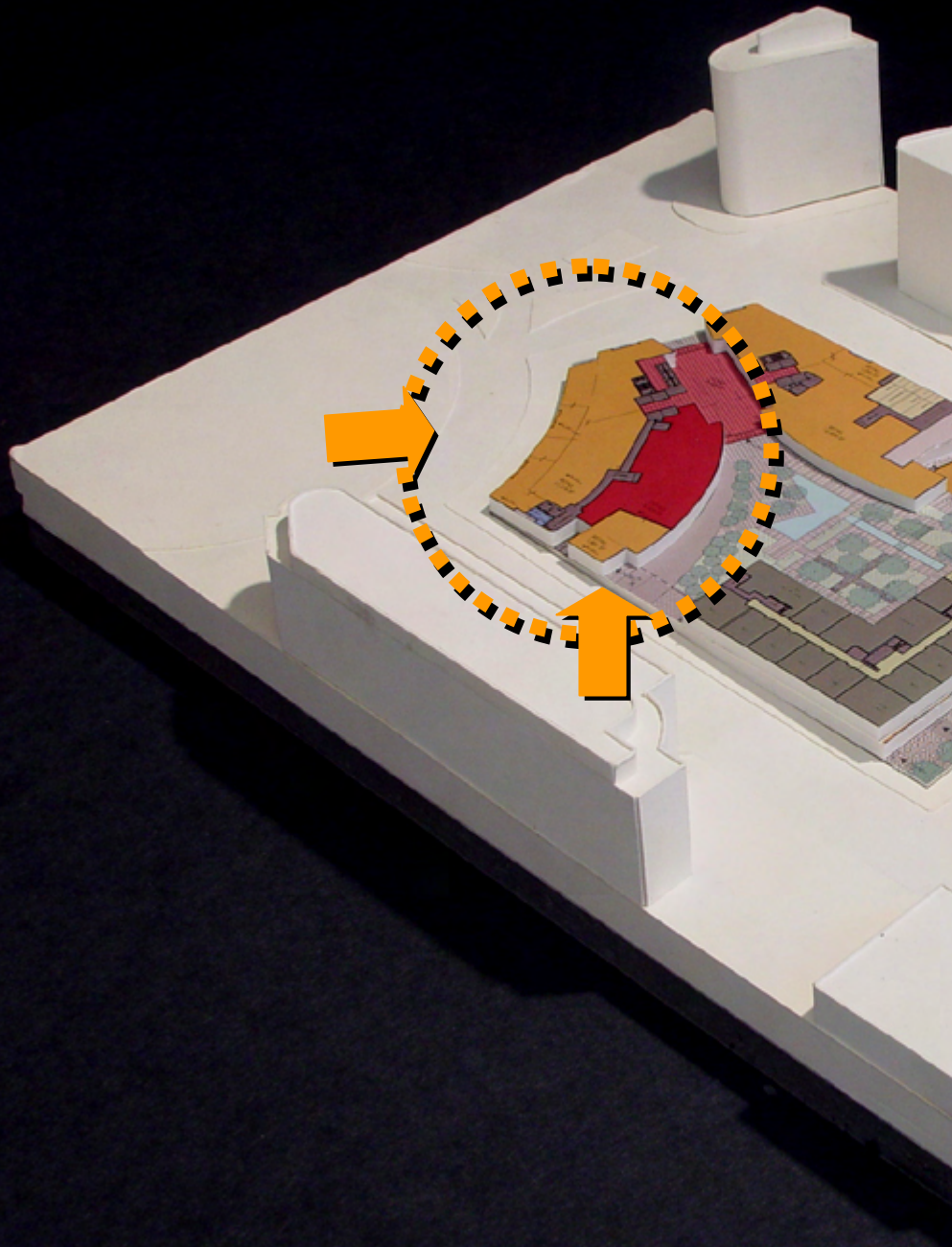



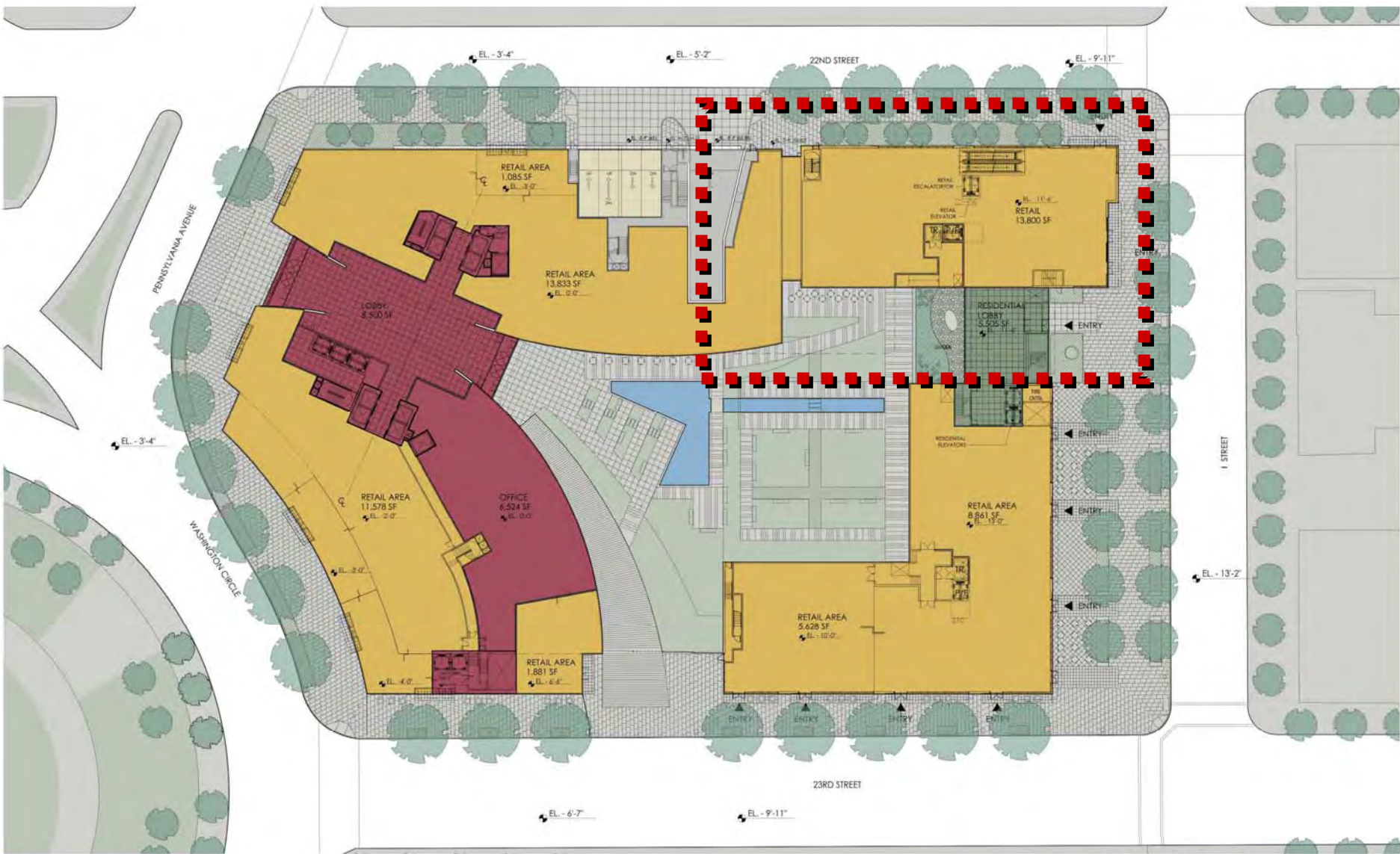

GROUND FLOOR RETAIL PLAN

COPYRIGHT © 2006 - PELL CLARK PELL ARCHITECTS

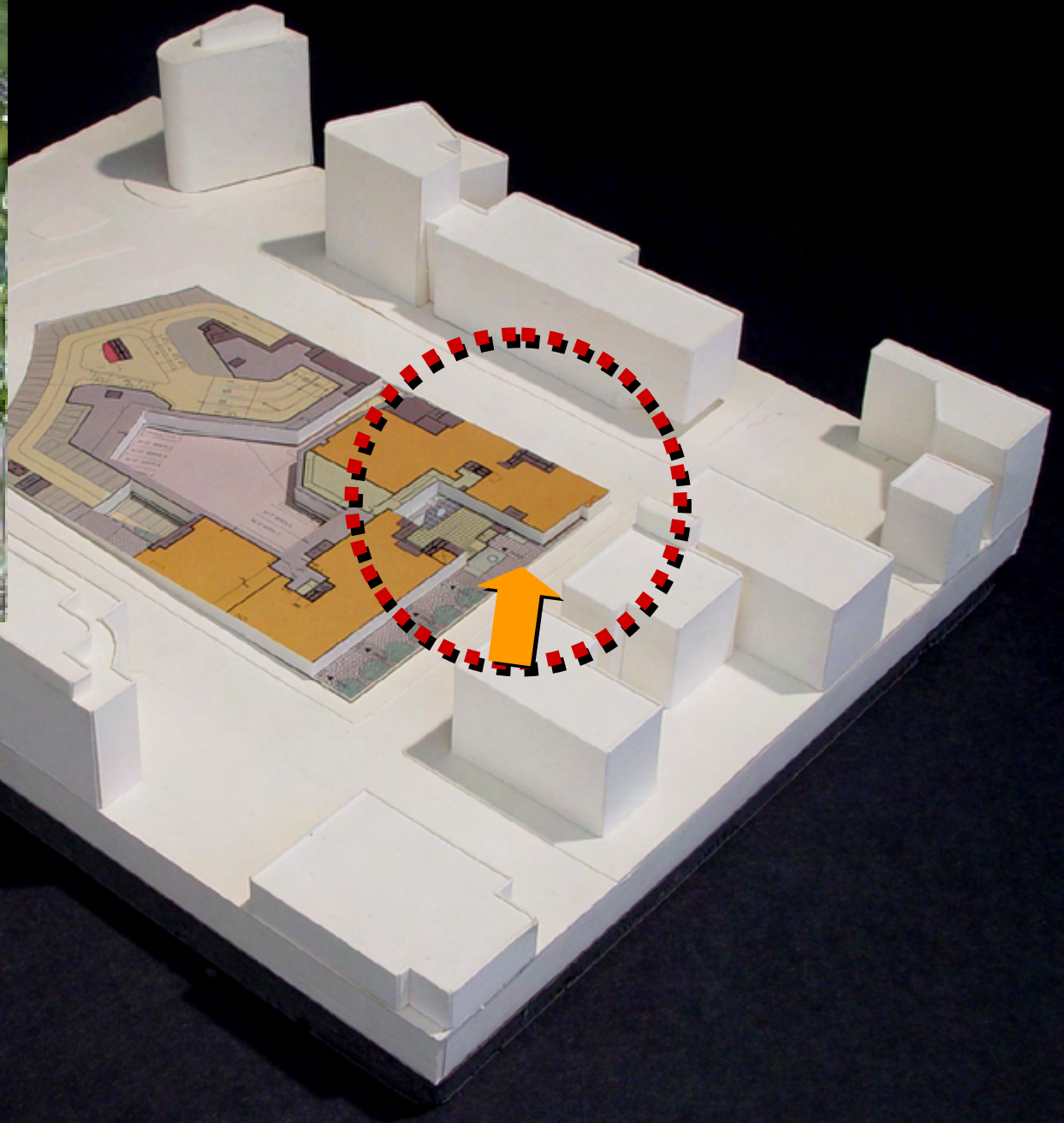

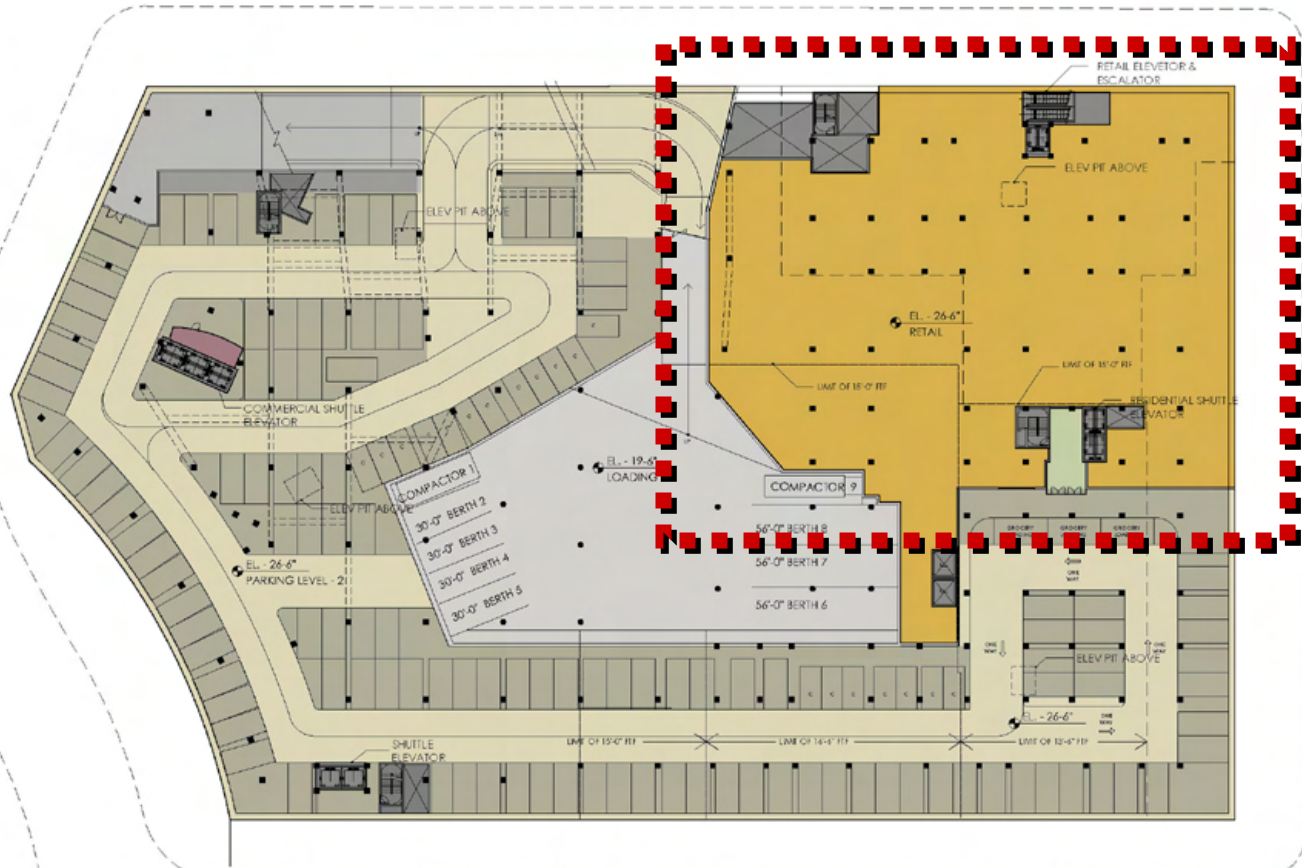

A2.02 PARKING LEVEL P2

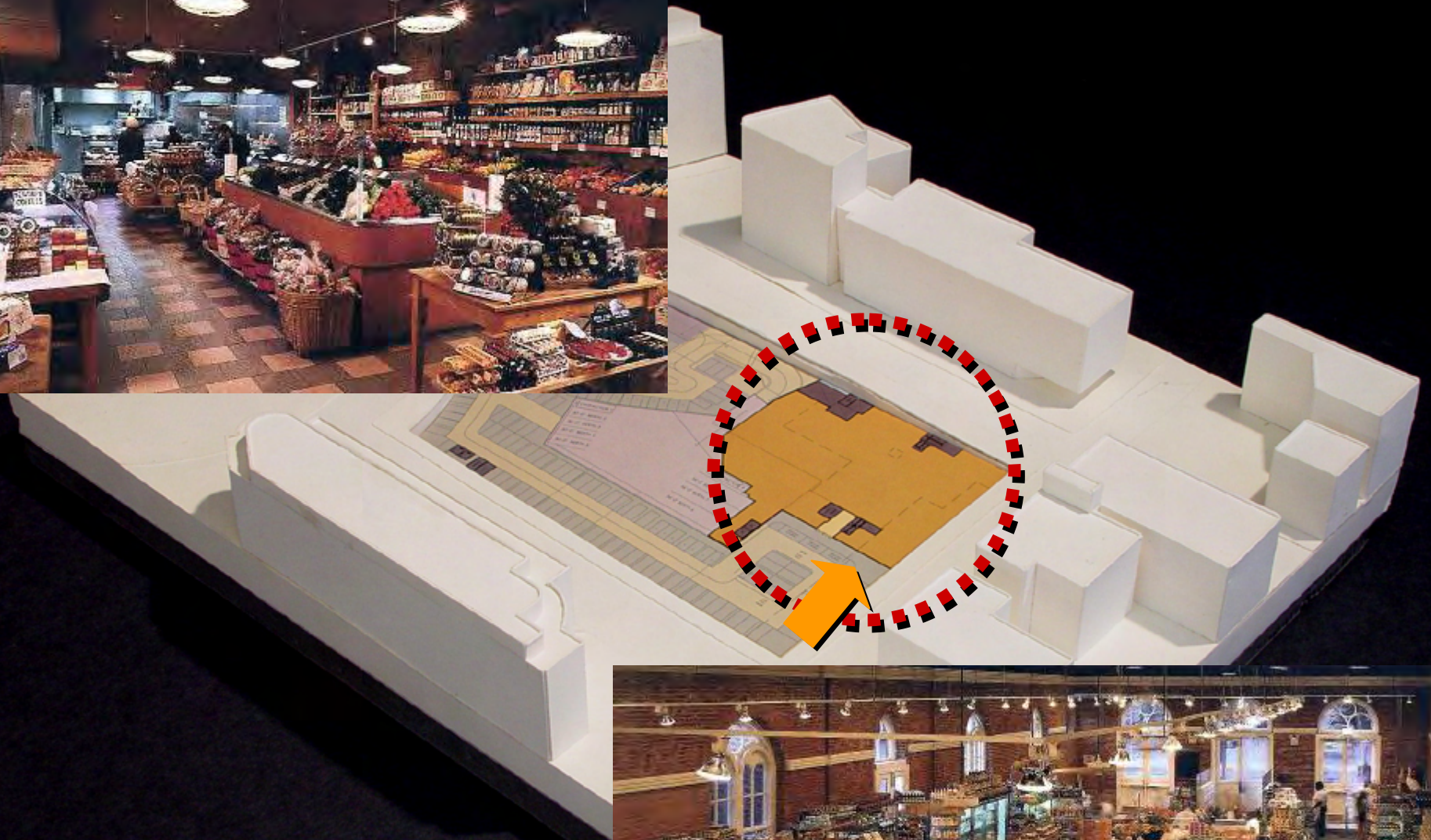



GROUND FLOOR RETAIL PLAN

COPYRIGHT © 2006 - PELL CLARK PELL ARCHITECTS







Jami Milanovich
Senior Associate
Wells & Associates LLC



Components

1. Vehicles
2. Pedestrians
3. Transit
4. Loading
5. Transportation Demand Management

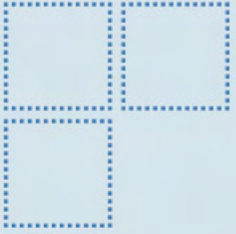

- A. Existing Conditions
- B. 2010 Conditions without the Proposed Development
- C. 2010 Conditions with the Proposed Development

Scope

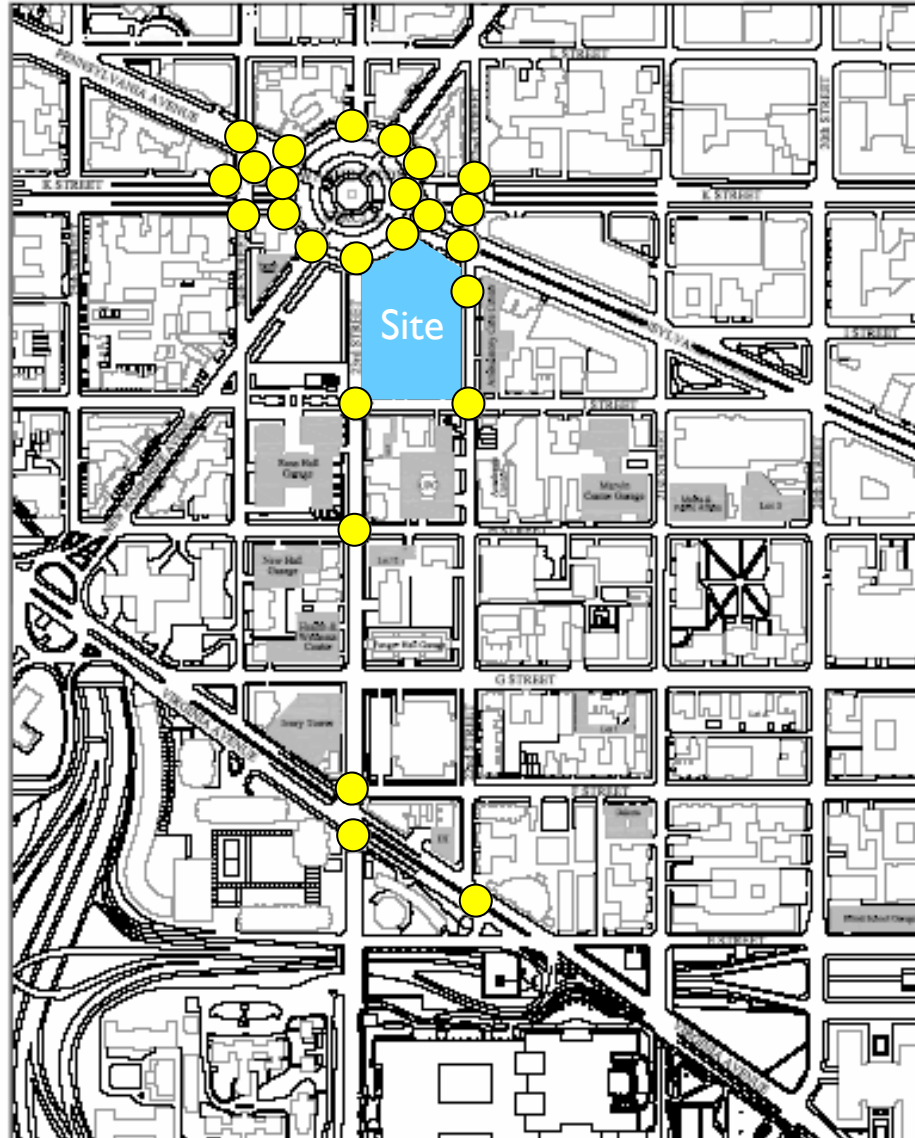

Functional Classification

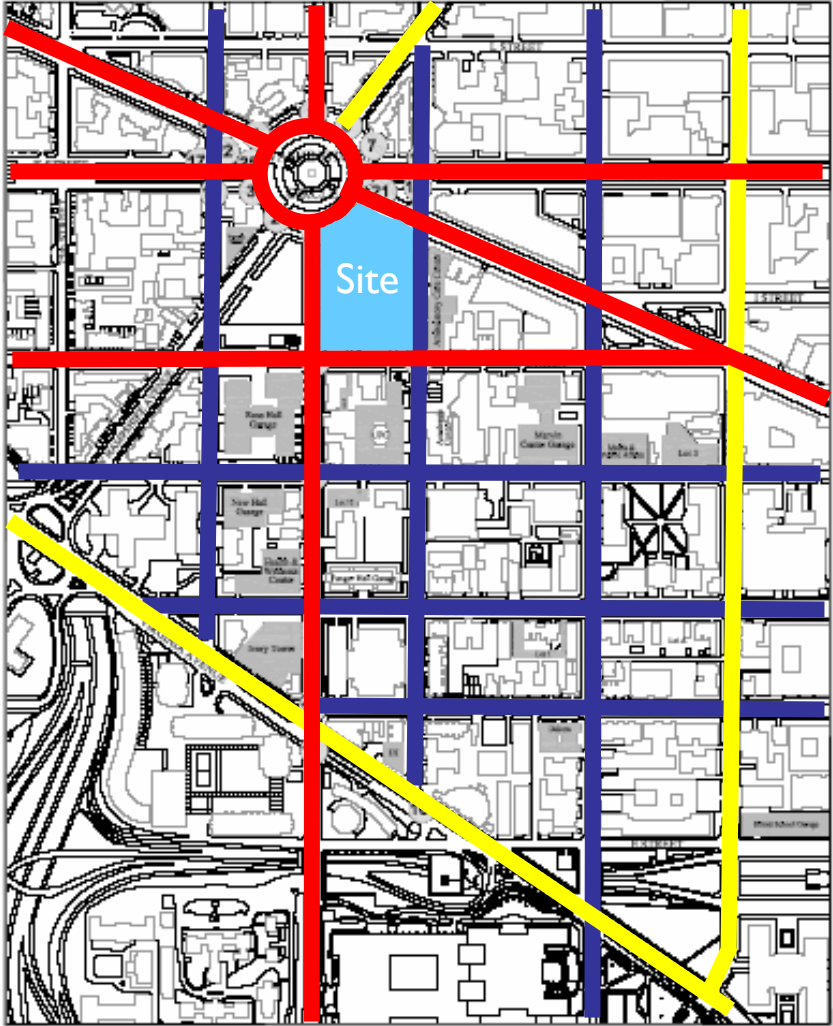

— Principal Arterial — Minor Arterial — Collector

Transit Routes

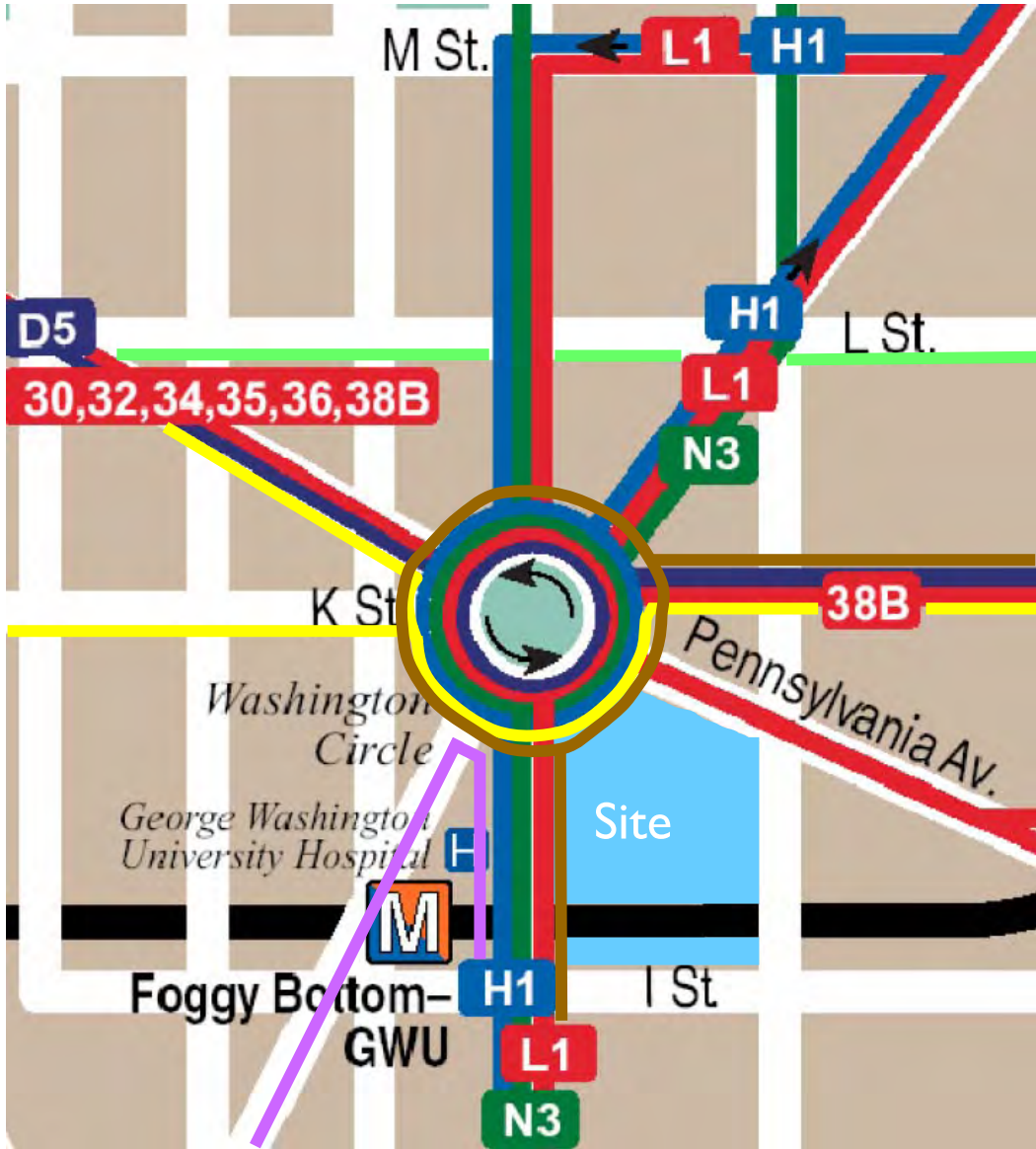

- Metrobus
- Maryland Commuter
- DC Circulator
- Kennedy Center Shuttle

D5

30,32,34,35,36,38B

M St.

L1

H1

L St.

H1

L1

N3

K St.

38B

Pennsylvania Av.

Washington Circle

George Washington University Hospital

Site

M

Foggy Bottom-GWU

H1

I St.

L1

N3

Existing Intersection Levels of Service

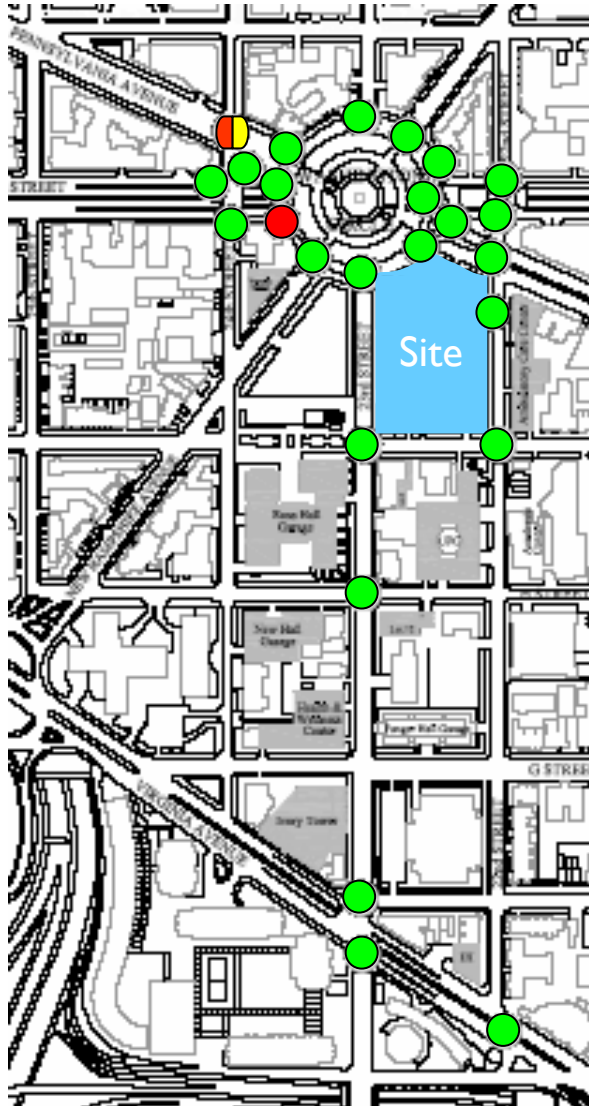

All intersections operate at overall acceptable levels of service ('D' or better) during the AM and PM peak hours except:

- Washington Circle/K Street (eastbound) (#3)
- 24th Street/Pennsylvania Avenue (#24)

- Overall LOS D or better
- Overall LOS E or better
- Overall LOS F or better

Trip Generation

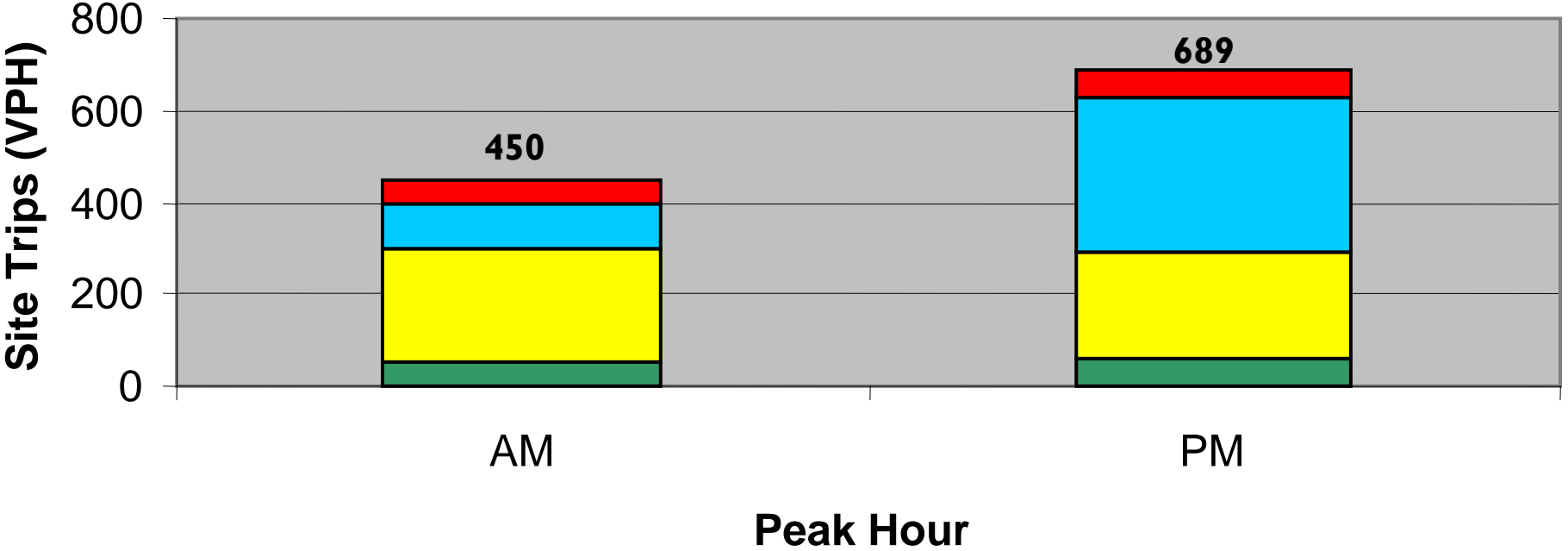

Future Conditions – Intersection Levels of Service

Without Proposed Development

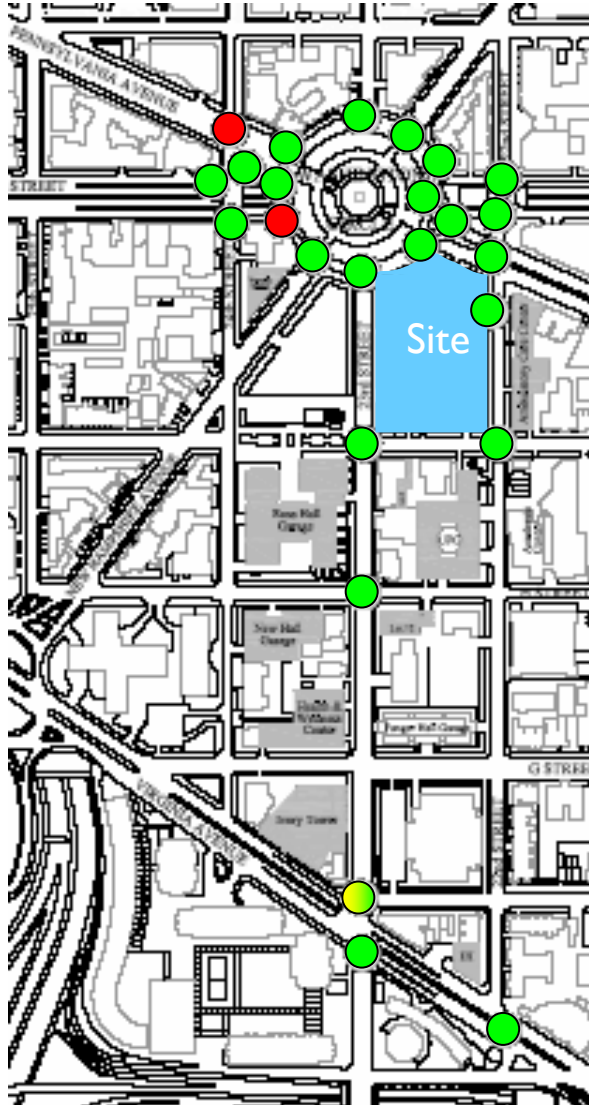

With Proposed Development & Mitigation

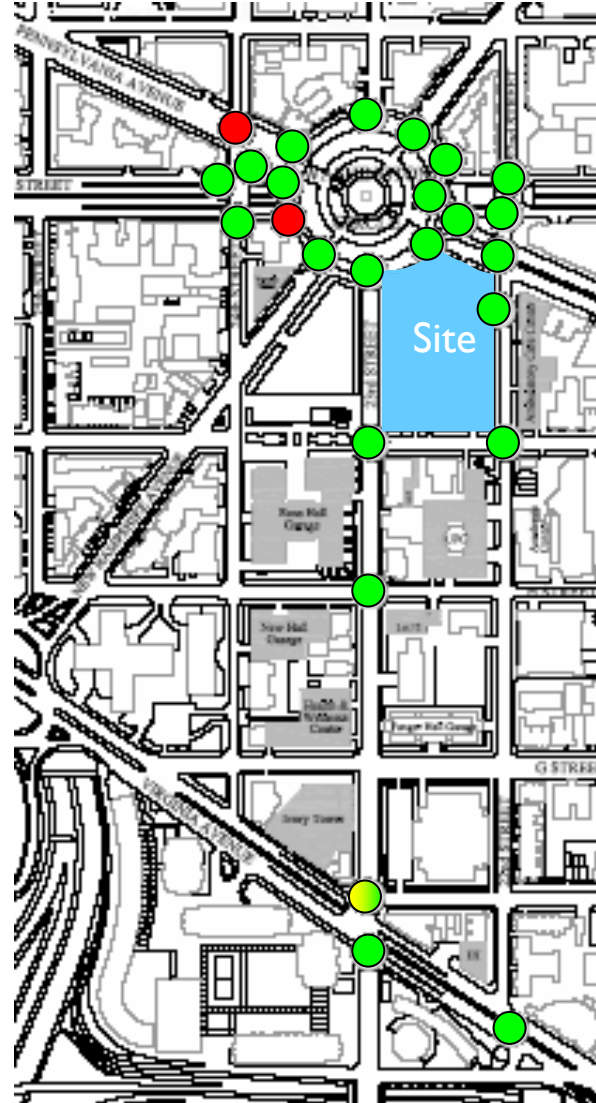

Proposed Mitigation Measures

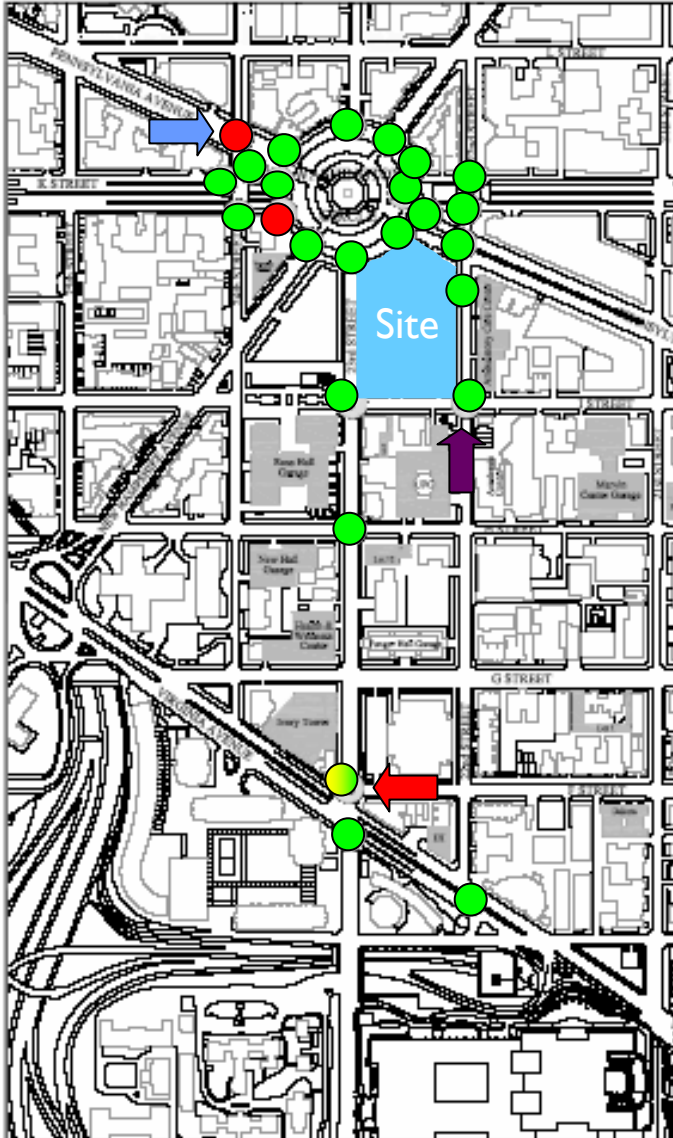

- 23rd Street / F Street / Virginia Avenue westbound (#10)
 - Adjust AM peak hour signal timings
- 22nd Street / I Street (#15)
 - Install traffic signal and restrict parking on south side of I Street
- 24th Street / Pennsylvania Avenue (#24)
 - Adjust AM and PM peak hour signal timings

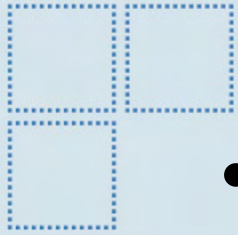

- Transit Incentives
- Information Dissemination
- Telecommuting Incentives
- Carpooling Incentives
- Parking for Car Sharing
- Bicycle Storage

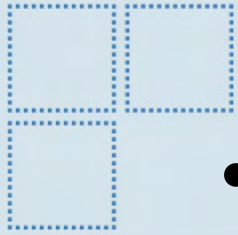

- On-site Loading
- Trucks Enter and Exit Front First
- Loading Dock Coordinator
- Provide Preferred Truck Circulation Route

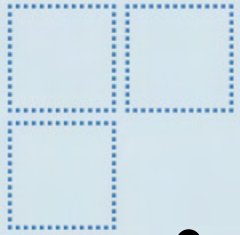

- The impact of the proposed development can be offset with the proposed transportation improvements
- TDM Program
- Truck Management Plan

