

# Pelham Redevelopment Project



The Pelham Redevelopment Project

## In planning for the redevelopment of Pelham Hall,

the University evaluated its space needs and institutional priorities in the context of its ongoing effort to foster and enhance the living and learning experience at the Mount Vernon Campus. Consistent with the existing Mount Vernon Campus Plan, the University is seeking to achieve an appropriate balance of academic

and student housing resources on the Campus while respecting and enhancing the residential environment.

The Pelham Redevelopment Project will provide approximately 287 beds for undergraduate students (and three apartments for professional staff) in a design that is in keeping with the architecture, scale and materials of the existing campus environment. The Project includes below-grade residential/campus life and building support space including a campus dining facility. This additional support space will enable the University to transition the use of functions in and around the traditional campus quadrangle (currently accommodating student support functions) to academic purposes, consistent with the tradition of the Campus as well as the planning principles of the Mount Vernon Campus Plan.

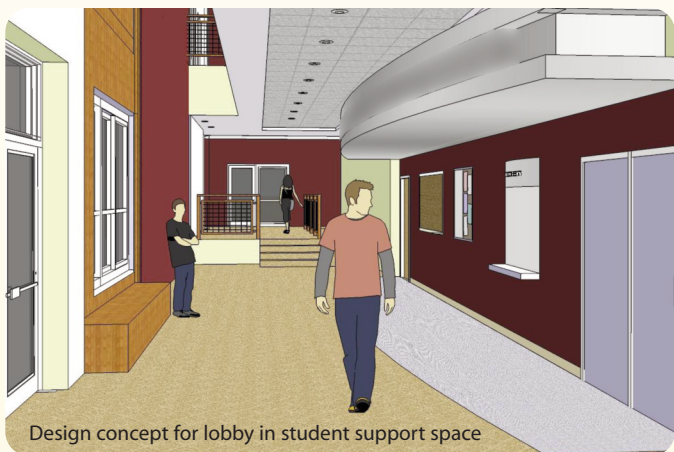

Design concept for lobby in student support space

### Quick facts on the Pelham Redevelopment Project

#### PROPOSED GROSS FLOOR AREA BUILDING USE

Approximately 92,300 square feet of GFA Undergraduate housing for 287 students, three staff apartments, and below-grade residential/campus life support space, including a campus dining facility

#### BUILDING DESIGN

The design of the building draws from the palette of existing materials prevalent throughout the campus, and features the use of brick and a slate-like hip roof

#### SUSTAINABLE DESIGN ELEMENTS

The building will incorporate a number of sustainable design elements and the University is seeking LEED Gold certification for this building

### We invite your continued participation

in the Pelham Redevelopment Project. For more information on this project, construction updates and information on other campus development initiatives, please visit [www.neighborhood.gwu.edu](http://www.neighborhood.gwu.edu) or contact the GW Office of Real Estate, 202-994-1700. Additional inquiries regarding the Mount Vernon Campus can be addressed to the Office of the Associate Vice President and Dean of Freshmen at 202-242-6609 or [avpdof@gwu.edu](mailto:avpdof@gwu.edu).

### CONSTRUCTION OVERVIEW

**Spring/Summer '08:**  
Site work (access road & utilities) & Demolition of existing dining hall

**Fall '08 - Spring '09:**  
Excavation and sheeting/shoring

**Spring '09-Spring '10:**  
Building construction

**Fall '10:**  
Project completion/ student move-in